



## SISTEMA DE SUJECIÓN DE HERRAMIENTAS





**SISTEMAS DE HERRAMIENTAS**

**PINZAS ER DE SUJECION**

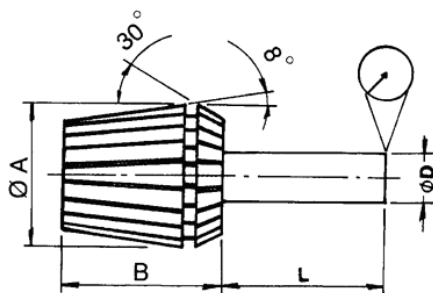

<b>PINZA ER-16 A=17 B=27 ( 0.5 – 10.0)</b>	
ST-250201	PINZA ER16 1- 0.5 mm
ST-250203	PINZA ER16 2 – 1mm
ST-250205	PINZA ER16 3 – 2 mm
ST-250206	PINZA ER16 4 – 3 mm
ST-250207	PINZA ER16 5 – 4mm
ST-250208	PINZA ER16 6 – 5 mm
ST-250209	PINZA ER16 7 – 6 mm
ST-250210	PINZA ER16 8 – 7 mm
ST-250211	PINZA ER16 9 – 8mm
ST-250212	PINZA ER16 10 – 9 mm

<b>PINZA ER-20 A=21 B=31 ( 1.0 – 13.0)</b>	
VX-V20020	PINZA ER20 2 – 1mm
VX-V20030	PINZA ER20 3 – 2 mm
VX-V20040	PINZA ER20 4 – 3 mm
VX-V20050	PINZA ER20 5 – 4 mm
VX-V20060	PINZA ER20 6 – 5 mm
VX-V20070	PINZA ER20 7 – 6 mm
VX-V20080	PINZA ER20 8 – 7 mm
VX-V20090	PINZA ER20 9 – 8 mm
VX-V20100	PINZA ER20 10 – 9 mm
VX-V20110	PINZA ER20 11 – 10 mm
VX-V20120	PINZA ER20 12 – 11 mm
VX-V20130	PINZA ER20 13 – 12 mm

<b>PINZA ER-25 A=26 B=35 ( 1.0 – 16.0)</b>	
ST-250217	PINZA ER25 2 – 1mm
ST-250219	PINZA ER25 3 – 2 mm
ST-250220	PINZA ER25 4 – 3 mm
ST-250221	PINZA ER25 5 – 4 mm
ST-250222	PINZA ER25 6 – 5 mm
ST-250223	PINZA ER25 7 – 6 mm
ST-250224	PINZA ER25 8 – 7 mm
ST-250225	PINZA ER25 9 – 8 mm
ST-250226	PINZA ER25 10 – 9 mm
ST-250227	PINZA ER25 11 – 10 mm
ST-250228	PINZA ER25 12 – 11 mm
ST-250229	PINZA ER25 13 – 12 mm
ST-250252	PINZA ER25 14 – 13 mm
ST-250253	PINZA ER25 15 – 14 mm
ST-250254	PINZA ER25 16 – 15 mm





<b>PINZA ER-32 A=33 B=40 ( 2.0 – 20.0)</b>	
ST-250233	PINZA ER32 3 – 2mm
ST-250235	PINZA ER32 4 – 3 mm
ST-250236	PINZA ER32 5 – 4 mm
ST-250237	PINZA ER32 6 – 5 mm
ST-250238	PINZA ER32 7 – 6 mm
ST-250239	PINZA ER32 8 – 7 mm
ST-250240	PINZA ER32 9 – 8 mm
ST-250241	PINZA ER32 10 – 9 mm
ST-250242	PINZA ER32 11 – 10 mm
ST-250243	PINZA ER32 12 – 11 mm
ST-250244	PINZA ER32 13 – 12 mm
ST-250245	PINZA ER32 14 – 13 mm
ST-250246	PINZA ER32 15 – 14 mm
ST-250247	PINZA ER32 16 – 15 mm
ST-250248	PINZA ER32 17 – 16 mm
ST-250249	PINZA ER32 18 – 17 mm
ST-250250	PINZA ER32 19 – 18 mm
ST-250251	PINZA ER32 20 – 19 mm

<b>PINZA ER-40 A=41 B=46 ( 3.0 – 26.0)</b>	
ST-250256	PINZA ER40 4 – 3 mm
ST-250257	PINZA ER40 5 – 4 mm
ST-250258	PINZA ER40 6 – 5 mm
ST-250259	PINZA ER40 7 – 6 mm
ST-250260	PINZA ER40 8 – 7 mm
ST-250261	PINZA ER40 9 – 8 mm
ST-250262	PINZA ER40 10 – 9 mm
ST-250263	PINZA ER40 11 – 10 mm
ST-250264	PINZA ER40 12 – 11 mm
ST-250265	PINZA ER40 13 – 12 mm
ST-250266	PINZA ER40 14 – 13 mm
ST-250267	PINZA ER40 15 – 14 mm
ST-250268	PINZA ER40 16 – 15 mm
ST-250269	PINZA ER40 17 – 16 mm
ST-250270	PINZA ER40 18 – 17 mm
ST-250271	PINZA ER40 19 – 20 mm
ST-250272	PINZA ER40 20 – 19 mm
ST-250273	PINZA ER40 21 – 20 mm
ST-250274	PINZA ER40 22 – 21 mm
ST-250275	PINZA ER40 23 – 22 mm
ST-250276	PINZA ER40 24 – 23 mm
ST-250277	PINZA ER40 25 – 24 mm
ST-250278	PINZA ER40 26 – 25 mm



**PORTA PINZAS ER CILINDRICOS**

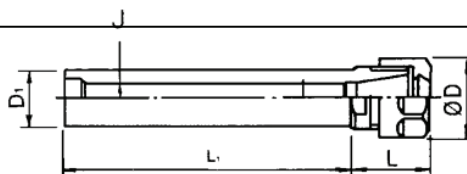

<b>CODIGO</b>	<b>PINZA</b>	<b>MEDIDAS D1xL1</b>
VX-V-501	<b>ER16</b>	Ø20x100 mm.
VX-V-503	<b>ER16</b>	Ø20x150 mm.
VX-V-505	<b>ER16</b>	Ø25x150 mm.

<b>CODIGO</b>	<b>PINZA</b>	<b>MEDIDAS D1xL1</b>
VX-V-507	<b>ER20</b>	Ø20x100 mm.
VX-V-508	<b>ER20</b>	Ø20x150 mm.
VX-V-509	<b>ER20</b>	Ø25x150 mm.



## MAQUINAS Y HERRAMIENTAS S.R.L.

Ejército de Los Andes 460  
Dorrego- Guaymallen-Mendoza  
Tel.:54 0261-4320692-4316949  
info@afmaquinas.com.ar  
www.afmaquinas.com.ar



CODIGO	PINZA	MEDIDAS D1xL1
VX-V-511	ER25	Ø20x100 mm.
VX-V-512	ER25	Ø20x150 mm.
VX-V-514	ER25	Ø25x150 mm.

CODIGO	PINZA	MEDIDAS D1xL1
VX-V-516	ER32	Ø25x80 mm.
VX-V-517	ER32	Ø32x100 mm.
VX-V-517A	ER32	Ø32x150 mm.

### PORTA PINZAS ER CONO MORSE



CODIGO	CONO	PINZA
VX-V-404	M3	ER16
VX-V-451	M3	ER20
VX-V-452	M3	ER25
VX-V-405	M3	ER32

CODIGO	CONO	PINZA
VX-V-406	M3	ER40
VX-V-407	M4	ER32
VX-V-408	M4	ER40
VX-V-410	M5	ER40

### PORTA PINZAS ER CONO ISO - NT



CODIGO	CONO	PINZA
VX-V-109	NT-30	ER25
VX-V-101	NT-30	ER32
VX-V-102	NT-30	ER40
VX-V-110	NT-40	ER32

CODIGO	CONO	PINZA
VX-V-104	NT-40	ER40
VX-V-106	NT-50	ER32
VX-V-107	NT-50	ER40



**PORTA PINZAS ER CONO BT**



CODIGO	CONO	PINZA
VX-V-715	<b>BT-30 x60</b>	ER20
VX-V-718	<b>BT-30 x60</b>	ER25
VX-V-700	<b>BT-30 x60</b>	ER32
VX-V-719	<b>BT-30 x70</b>	ER40
VX-V-720	<b>BT-40 x70</b>	ER25

CODIGO	CONO	PINZA
VX-V-703A	<b>BT-40 x70</b>	ER32
VX-V-704	<b>BT-40 x80</b>	ER40
VX-V-705	<b>BT-50 x100</b>	ER32
VX-V-706B	<b>BT-50 x100</b>	ER40

**JUEGO PORTA PINZAS ER CONO MORSE**



CODIGO	CONO / PINZA	CANT. PIEZAS
VX-V-443	<b>MT3 - ER25</b>	15
VX-V-421	<b>MT3 - ER32</b>	18
VX-V-424	<b>MT3 - ER40</b>	23
VX-V-427	<b>MT4 - ER32</b>	18
VX-V-430	<b>MT4 - ER40</b>	23
VX-V-224	<b>NT30 - ER25</b>	15
VX-V-201	<b>NT30 - ER32</b>	18
VX-V-204	<b>NT30 - ER40</b>	23
VX-V-207	<b>NT40 - ER32</b>	18
VX-V-210	<b>NT40 - ER40</b>	23
VX-V-217	<b>NT50 - ER40</b>	23
VX-V-783B	<b>BT30 - ER25</b>	15
VX-V-785	<b>BT30 - ER32</b>	18
VX-V-788	<b>BT40 - ER32</b>	18
VX-V-794	<b>BT40 - ER40</b>	23
VX-V-797	<b>BT50 - ER40</b>	23



**ESPIGAS PARA MANDRIL**



<b>CODIGO</b>	<b>CONO</b>
ST-398098	<b>MT2 – J3</b>
ST-398099	<b>MT2 – J6</b>
ST-398100	<b>MT2 – J33</b>
ST-398101	<b>MT3 – J3</b>
ST-398102	<b>MT3 – J6</b>
ST-398103	<b>MT3 – J33</b>
ST-398104	<b>MT4 – J3</b>
ST-398105	<b>MT4 – J6</b>
ST-398106	<b>MT4 – J33</b>
VX-VJ-103	<b>NT30 – J6</b>
VX-VJ-106	<b>NT40 – J6</b>
VX-VJ-109	<b>NT50 – J6</b>

**CONOS DE REDUCCION**

<b>CODIGO</b>	<b>CONO</b>
ST- 392000	<b>MT1-MT2</b>
ST- 392001	<b>MT1-MT3</b>
ST- 392002	<b>MT2-MT3</b>
ST- 392003	<b>MT2-MT4</b>
ST- 392010	<b>MT2-MT5</b>
ST- 392004	<b>MT3-MT4</b>
ST- 392005	<b>MT3-MT5</b>
ST- 392006	<b>MT4-MT5</b>
ST- 392007	<b>MT4-MT6</b>
ST- 392008	<b>MT5-MT6</b>



<b>CODIGO</b>	<b>CONO</b>
VX-VI-101	<b>MT1-NT30</b>
VX-VI-102	<b>MT2-NT30</b>
VX-VI-103	<b>MT3-NT30</b>
VX-VI-104	<b>MT1-NT40</b>
VX-VI-105	<b>MT2-NT40</b>
VX-VI-106	<b>MT3-NT40</b>
VX-VI-107	<b>MT4-NT40</b>
VX-VI-109	<b>MT4-NT50</b>
VX-VI-110	<b>MT5-NT50</b>





**ARBOL PORTA FRESA**

<b>CODIGO</b>	<b>CONO</b>
VX-VF-136	<b>MT3 – Ø27</b>
VX-VF-137	<b>MT4 – Ø27</b>
VX-VF-120	<b>NT30 – Ø22</b>
VX-VF-121	<b>NT30 – Ø27</b>
VX-VF-122	<b>NT30 – Ø32</b>
VX-VF-123	<b>NT40 – Ø22</b>
VX-VF-124	<b>NT40 – Ø27</b>
VX-VF-125	<b>NT40 – Ø32</b>
VX-VF-126	<b>NT40 – Ø40</b>
VX-VF-128	<b>NT50 – Ø22</b>
VX-VF-129	<b>NT50 – Ø27</b>
VX-VF-130	<b>NT50 – Ø32</b>
VX-VF-131	<b>NT50 – Ø40</b>
VX-BT-150	<b>BT30 – Ø22</b>
VX-BT-151	<b>BT30 – Ø27</b>
VX-BT-152	<b>BT40 – Ø22</b>
VX-BT-153	<b>BT40 – Ø27</b>
VX-BT-154	<b>BT40 – Ø32</b>
VX-BT-157	<b>BT40 – Ø40</b>
VX-BT-158	<b>BT50 – Ø22</b>
VX-BT-160	<b>BT50 – Ø27</b>
VX-BT-163	<b>BT50 – Ø32</b>
VX-BT-166	<b>BT50 – Ø40</b>



**DISPOSITIVO DE MONTAJE**



<b>CODIGO</b>	<b>CONO</b>	<b>PESO</b>
VX-VTS-BT30	<b>ISO-BT-NT(30)</b>	13kg
VX-VTS-BT40	<b>ISO-BT-NT(30)</b>	13kg
VX-VTS-BT50	<b>ISO-BT-NT(30)</b>	13kg



**RACK PORTA HERRAMIENTA**



CODIGO	CONO	DIMENSIONES
VX-VTTR-BT30	ISO-BT-NT(30)	595x143x225mm
VX-VTTR-BT40	ISO-BT-NT(40)	
VX-VTTR-BT50	ISO-BT-NT(50)	

CODIGO	CONO	DIMENSIONES
VX-VTTS-BT30	ISO-BT-NT(30)	48x138x65mm
VX-VTTS-BT40	ISO-BT-NT(40)	63x138x74mm
VX-VTTS-BT50	ISO-BT-NT(50)	93x138x104mm

**ROSCADORES REVERSIBLES**



CODIGO	Ø MACHO	ADAPTADOR	MAX. RPM	Ø DEL CUERPO	Ø DEL PORTA	PESO
VX-VTA7	M2-M7	FC10/FC11	1500	52mm	25mm	1.2 kg
VX-VTA12	M3-M12	FC20/FC21	1000	73.5mm	32mm	3kg
VX-VTA20	M8-M20	FC30/FC31	600	91mm	40mm	5.6kg

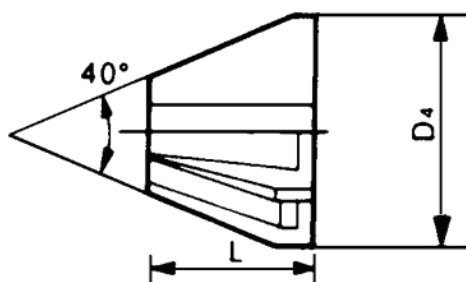

CODIGO	BOQUILLA	D4 x L
VX-FC10	Ø2.5-4.5mm	Ø16x11mm
VX-FC11	Ø4.5-6.5mm	Ø16x11mm
VX-FC20	Ø4.5-7.5mm	Ø21.5x13mm
VX-FC21	Ø7.5-10mm	Ø21.5x13mm
VX-FC30	Ø8-16mm	Ø26.5x15mm





**MANDRILES**



**AUTOAJUSTABLES**

CODIGO	CAPACIDAD	CONO	MARCA
CO-14417	Ø 0 – 13mm	J33	RI-LE
CO-14418	Ø 3 – 16mm	J33	RI-LE
VX-11066	Ø 0 – 10mm	J33	VERTEX
VX-11071	Ø 0 – 13mm	J33	VERTEX
VX-11073	Ø 3 – 16mm	J6	VERTEX



**CON LLAVE**

CODIGO	CAPACIDAD	CONO / ROSCA	MARCA
VX-10041	Ø 1 – 13mm	CONO J33	VERTEX
VX-10061	Ø 1 – 16mm	CONO J6	VERTEX
VX-10073	Ø 3 – 19mm	CONO J3	VERTEX
BA-909335	Ø 3 – 16mm	CONO J3	EXPERTO
BA-909408	Ø 3 – 16mm	CONO J33	EXPERTO
BA-909343	Ø 5 – 20mm	CONO J3	EXPERTO
BA-908967	Ø 1 – 10mm	ROSCA 3/8x24	EXPERTO
BA-908975	Ø 1,5 – 13mm	ROSCA 1/2x20	EXPERTO



**KIT CABEZALES ALEASDORES**

CODIGO	CAPACIDAD	CONO	PESO
VX-BVH-102	Ø 10 – 240mm	MT-3	7kg
VX-BVH-103	Ø 10 – 240mm	MT-4	7kg
VX-BVH-104	Ø 10 – 240mm	MT-5	7kg
VX-BVH-106	Ø 10 – 240mm	NT-30	7kg
VX-BVH-107	Ø 10 – 240mm	NT-40	7kg
VX-BVH-109	Ø 10 – 240mm	BT-40	10kg

